

### Stainless Steel Kitchen Sink Series

For a quick kitchen make over, the Sinor double bowl kitchen sink kit offers an all-in-one solution to meet your needs. The Sinor kitchen sink comes with the matching drains. The ADA compliant depth allows for wheelchair accessible installations. With convenient top mount installation, Sinor sinks can be dropped in and ready to go quickly and efficiently.



The kitchen is the most commonly remodeled room in the home, and the counter and sink are the most frequently replaced items. When it is time to choose a new sink for your kitchen, you have many choices, not only in the material and shape of the sink but the configuration as well. Most sink companies have an array of varying sizes, with single and double bowl sinks being the two most common configurations. Both have their positive and negative attributes that may make one a better fit for your kitchen. We will outline the differences between the below, so you can decide which one will work better in your space.

#### Safe & Environmental-Friendly

Overflowing of the kitchen sink is not only a nuisance but also a potential hazard. The 'Overflow Protection' which drains water safety out of the sink is a definite advantage to have in any modern kitchen.



# Stainless Steel Kitchen Sink



Corrosion Resistant



Excellent Quality



Easy Installation

- Stainless Steel
- High Quality
- Hairline / Silver Pearl Finishing (Follow By Type)
- Easy Installation
- Thickness & Durability

#### Application:

- Kitchen • Restaurant
- Café • Home Stay
- Budget Hotel
- Home / Houses

#### PREMIUM SERIES



SN-6248



#### Technical Drawing:



Stainless Steel Single Bowl Kitchen Sink  
Size: 620 x 480 x D230mm x (T0.8mm)

Material: Stainless Steel  
Finishing: Hairline  
Packing: 1/Box , 6/Ctn

#### PREMIUM SERIES



SN-8046



#### Technical Drawing:

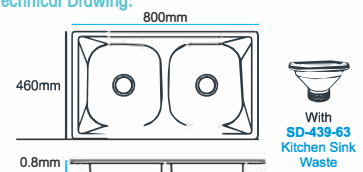

Stainless Steel Double Bowl Kitchen Sink  
Size: 800 x 460 x 210mm x (T0.8mm)

Material: Stainless Steel  
Finishing: Hairline  
Packing: 1/Box , 6/Ctn

#### PREMIUM SERIES



SN-10549



#### Technical Drawing:

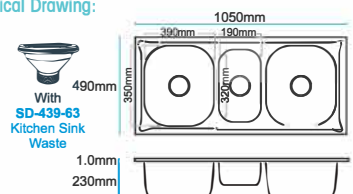

Stainless Steel Triple Basin Kitchen Sink  
Size: 1050 x 490 x D230mm x (T1.0mm)

Material: Stainless Steel  
Finishing: Hairline  
Packing: 1/Box , 3/Ctn

#### PREMIUM SERIES



SN-10646



#### Technical Drawing:

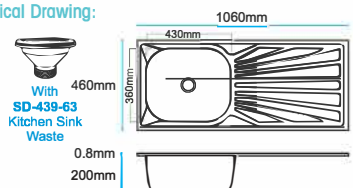

Single Bowl Kitchen Sink With Drainboard  
Size: 1060 x 460 x D200mm x (T0.8mm)

Material: Stainless Steel  
Finishing: Hairline  
Packing: 1/Box , 6/Ctn

### DEVELOPER SERIES

### Stainless Steel Kitchen Sink Series

For a quick kitchen make over, the Sinor double bowl kitchen sink kit offers an all-in-one solution to meet your needs. The Sinor kitchen sink comes with the matching drains. The ADA compliant depth allows for wheelchair accessible installations. With convenient top mount installation, Sinor sinks can be dropped in and ready to go quickly and efficiently.



The kitchen is the most commonly remodeled room in the home, and the counter and sink are the most frequently replaced items. When it is time to choose a new sink for your kitchen, you have many choices, not only in the material and shape of the sink but the configuration as well. Most sink companies have an array of varying sizes, with single and double bowl sinks being the two most common configurations. Both have their positive and negative attributes that may make one a better fit for your kitchen. We will outline the differences between the below, so you can decide which one will work better in your space.



## Stainless Steel Kitchen Sink



Corrosion Resistant



Excellent Quality



Easy Installation

### Safe & Environmental-Friendly

Overflowing of the kitchen sink is not only a nuisance but also a potential hazard. The 'Overflow Protection' which drains water safety out of the sink is a definite advantage to have in any modern kitchen.

- |  |   |
|--|---|
| <ul style="list-style-type: none"> <li>• Stainless Steel</li> <li>• High Quality</li> <li>• Hairline / Silver Pearl Finishing (Follow By Type)</li> <li>• Easy Installation</li> <li>• Thickness &amp; Durability</li> </ul> | <p><b>Application:</b></p> <ul style="list-style-type: none"> <li>• Kitchen</li> <li>• Restaurant • Café</li> <li>• Home Stay</li> <li>• Budget Hotel</li> <li>• Home / Houses</li> </ul> |
|--|---|

#### DEVELOPER SERIES

#### Technical Drawing:

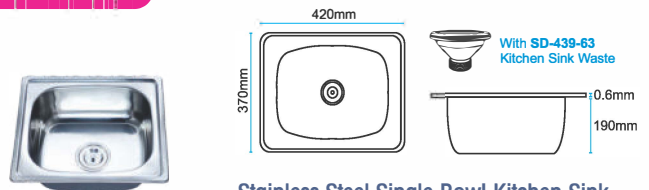

SN-4237



Stainless Steel Single Bowl Kitchen Sink

Size: 420 x 370 x D190mm x (T0.6mm)

Material: Stainless Steel

Finishing: Silver Pearl

Packing: 1/Box , 10/Ctn

#### DEVELOPER SERIES

#### Technical Drawing:

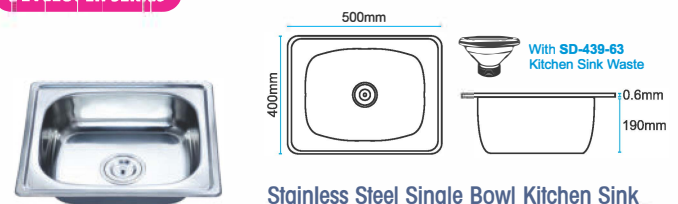

SN-5040



Stainless Steel Single Bowl Kitchen Sink

Size: 500 x 400 x D190mm x (T0.6mm)

Material: Stainless Steel

Finishing: Silver Pearl

Packing: 1/Box , 10/Ctn

#### DEVELOPER SERIES

#### Technical Drawing:

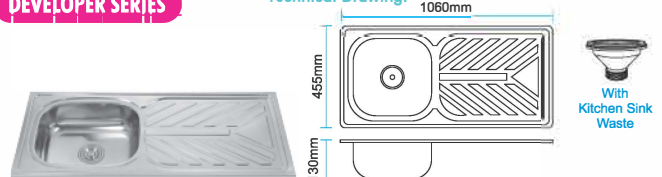

SN-1842-P



S/Steel Kitchen Sink With Drainboard

Size: 1060mm x 455mm x D130mm

Material: Stainless Steel

Finishing: Polish

Packing: 1/Box , 10/Ctn

**Premium Series Undermount Kitchen Sink**

*Premium* **SUS304 Stainless Steel Nano Undermount Kitchen Sink Series**



Too many different types of kitchen sink available in the market that you feel is hard to filter and choose the most suitable one for your kitchen? Here's a simple solution for you. Just go for the best quality one. But which sink is the best for the kitchen? Well, the best kitchen sink is the one that appears to be practical and convenient for kitchen needs - and most importantly - easy to clean and can last for a long time. If you are looking for a kitchen sink that fulfills all these conditions, then a **NANOTECH** sink may be what you need. Here are a few benefits that you probably can't find on any other kitchen sink except for the **NANOTECH** sink:

**Come With Sink Drain Waste Strainer**

- **SUS304 STAINLESS STEEL**
- SUS304 Stainless Steel
- High Quality
- Hairline Finishing
- Easy Installation
- Thickness & Durability
- Nano Technology
- Easy To Clean And Maintain

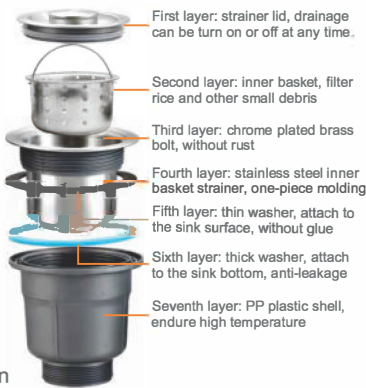

**UNDERMOUNT SERIES**

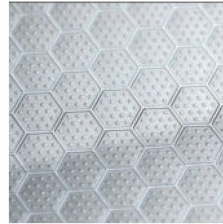

**Honeycomb embossed** core technology, self-contained nano antibacterial protective layer, effective antibacterial, escort for kitchen hygiene



**Honeycomb Embossed**  
Scratch Resistant  
Not Easy To Scratch

Technical Drawing:

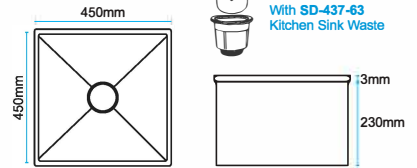

**Nano Single Bowl Kitchen Sink**  
Size: 450 x 450 x D230mm x (T3.0mm)  
Material: SUS304 Stainless Steel  
Finishing: Nano Silver  
Packing: 1/Box , 5/Ctn

**UMS-4545-NS**



Technical Drawing:

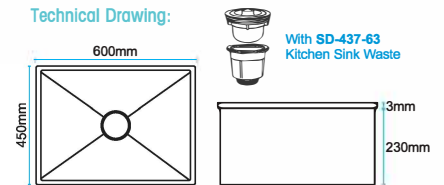

**Nano Single Bowl Kitchen Sink**  
Size: 600 x 450 x D230mm x (T3.0mm)  
Material: SUS304 Stainless Steel  
Finishing: Nano Silver  
Packing: 1/Box , 5/Ctn

**UMS-6045-NS**



Technical Drawing:

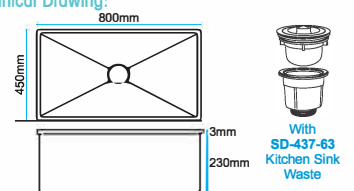

**Nano Single Bowl Kitchen Sink**  
Size: 800 x 450 x D230mm x (T3.0mm)  
Material: SUS304 Stainless Steel  
Finishing: Nano silver  
Packing: 1/Box , 5/Ctn

**UMS-8045-NS**



Technical Drawing:

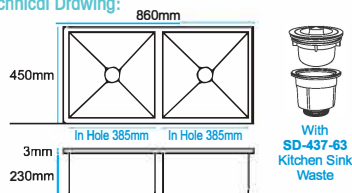

**Nano Double Bowl Kitchen Sink**  
Size: 860 x 450 x D230mm x (T3.0mm)  
Material: SUS304 Stainless Steel  
Finishing: Nano Silver  
Packing: 1/Box , 3/Ctn

**UMS-8645-NS**



Technical Drawing:

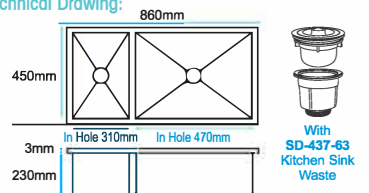

**Nano BS Bowl Kitchen Sink**  
Size: 860 x 450 x D230mm x (T3.0mm)  
Material: SUS304 Stainless Steel  
Finishing: Nano silver  
Packing: 1/Box , 3/Ctn

**UMS-8645-BS-NS**



# Premium Series Undermount Kitchen Sink

*Premium* **SUS304 Stainless Steel Nano Undermount Kitchen Sink Series**



Too many different types of kitchen sink available in the market that you feel is hard to filter and choose the most suitable one for your kitchen? Here's a simple solution for you. Just go for the best quality one. But which sink is the best for the kitchen? Well, the best kitchen sink is the one that appears to be practical and convenient for kitchen needs - and most importantly - easy to clean and can last for a long time. If you are looking for a kitchen sink that fulfills all these conditions, then a **NANOTECH** sink may be what you need. Here are a few benefits that you probably can't find on any other kitchen sink except for the **NANOTECH** sink:

**Come With Sink Drain Waste Strainer**

- SUS304 Stainless Steel
- High Quality
- Hairline Finishing
- Easy Installation
- Thickness & Durability
- Nano Technology
- Easy To Clean And Maintain

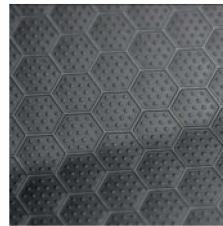
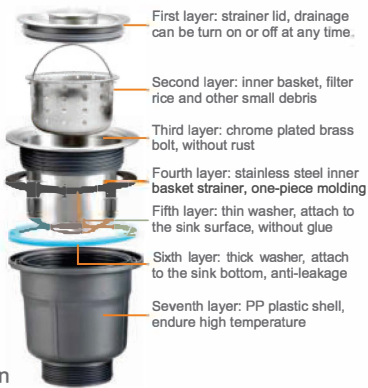

**Honeycomb embossed** core technology, self-contained nano antibacterial protective layer, effective antibacterial, escort for kitchen hygiene

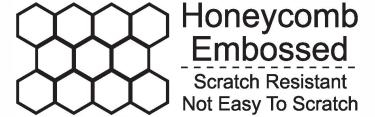

Technical Drawing:

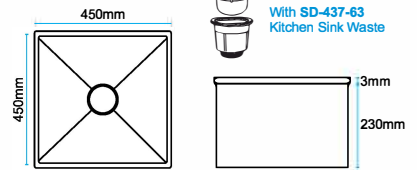

**Nano Single Bowl Kitchen Sink**  
 Size: 450 x 450 x D230mm x (T3.0mm)  
 Material: SUS304 Stainless Steel  
 Finishing: Nano Black  
 Packing: 1/Box , 5/Ctn



Technical Drawing:

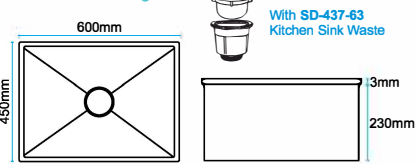

**Nano Single Bowl Kitchen Sink**  
 Size: 600 x 450 x D230mm x (T3.0mm)  
 Material: SUS304 Stainless Steel  
 Finishing: Nano Black  
 Packing: 1/Box , 5/Ctn



Technical Drawing:

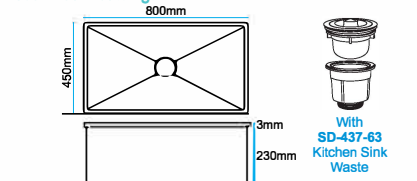

**Nano Single Bowl Kitchen Sink**  
 Size: 800 x 450 x D230mm x (T3.0mm)  
 Material: SUS304 Stainless Steel  
 Finishing: Nano Black  
 Packing: 1/Box , 5/Ctn



Technical Drawing:

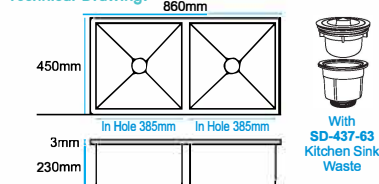

**Nano Double Bowl Kitchen Sink**  
 Size: 860 x 450 x D230mm x (T3.0mm)  
 Material: SUS304 Stainless Steel  
 Finishing: Nano Black  
 Packing: 1/Box , 3/Ctn



Technical Drawing:

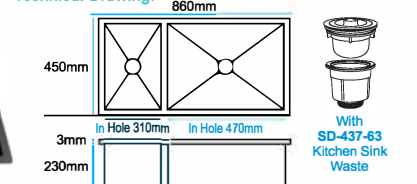

**Nano BS Bowl Kitchen Sink**  
 Size: 860 x 450 x D230mm x (T3.0mm)  
 Material: SUS304 Stainless Steel  
 Finishing: Nano Black  
 Packing: 1/Box , 3/Ctn



# Kitchen Sink With Faucet

**PREMIUM SERIES**

## NANO GUN METAL UNDERMOUNT KITCHEN SINK WITH FAUCET

This kitchen sink is installed above counter top, Sinor Premium single bowl gives you the needed space for washing and stacking dishes. The gun metal nano finish ensures the sink goes with your home decor and washes clean with soapy water.

Kitchen Sink is designed for unparalleled resistance to impact and thermal shock – heat-resistant. The deep Single bowl sink can accommodate your largest kitchenware.

Our Kitchen set includes the sink, matching premium glass rinser, basket strainer, soap dispenser, cup & bottle washer & multi functional water fall kitchen sink tap. These products provide superior performance because of features such as scratch resistance and gun metal nano finish.

**Outside size:**

750mm (length) x 460mm (width) x 220mm (depth) ; R10 radius corners, Over-sized bowl will accommodate your largest roasting pans, baking sheet.

We put a lot of effort into manufacturing quality products that meet our customers' expectations. Our products are premium quality. We believe in quality assurance and excellent customer service. Buy with confidence and you will not regret your purchase.



## 4 Style Water Tap

Say goodbye to the faucet single water mode



**Package Included:**

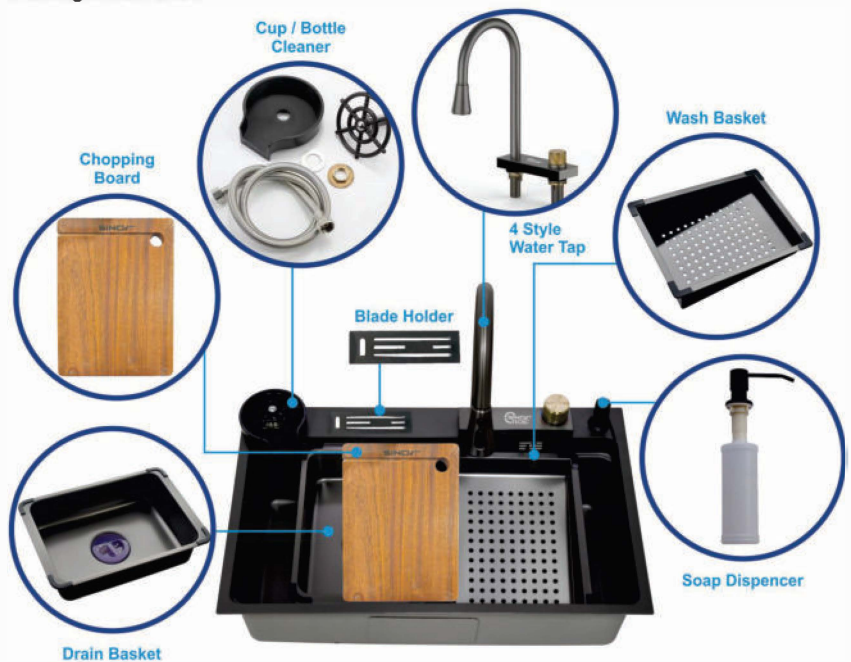

**Honeycomb embossed** core technology, self-contained nano antibacterial protective layer, effective antibacterial, escort for kitchen hygiene



High-density embossed particles protect the surface of the sink, avoiding scratches and scratches

Nano antibacterial technology, dripping into beads, oil-resistant and easy to clean



**Honeycomb Embossed Kitchen Sink**

The oil stains are washed away by clear water, and the dripping water forms beads and falls naturally

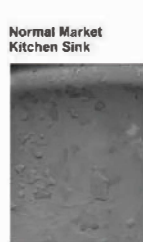

**Normal Market Kitchen Sink**

Oil stains are always attached to the surface of the sink and cannot be easily washed away by clean water

**Technical Drawing:**

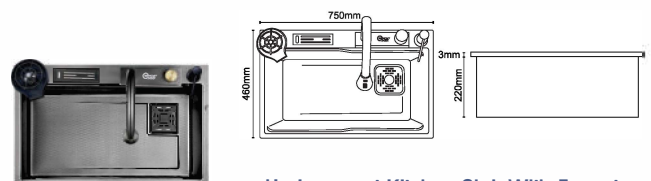

**UMS-7546-GM**

**Undermount Kitchen Sink With Faucet**  
 Size: 750mm x 460mm x D220mm  
 Material: SUS304 Stainless Steel  
 Finishing: Nano Gun Metal  
 Packing: 1/Box

### Extendable Stainless Steel Sink Drain Basket

This stainless steel drain shelf can be an item that can be the best partner to your kitchen sink.

Features:

- Extendable in length to suit different sized sinks
- multipurpose kitchen ware a solution for you to dry the dishes, fruits and vegetables, fast to drain the water.

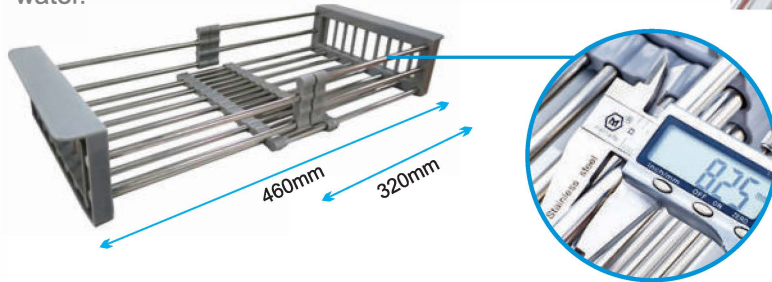

Technical Drawing:

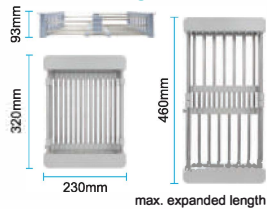

Stainless Steel Telescopic Drain Basket

Size: (320/460) x 230 x 93mm

Material: Stainless Steel + Plastic

Finishing: Chromed

Packing: 1/Box , 50/Ctn

**SN-DB-5623**



### Stainless Steel Folding Roll Up Drainer Shelf

A solution for you to dry the dishes, fruits and vegetables, fast to drain the water. Help you hold fruits, vegetables and dishes while washing them, and easy let them dry.

Features:

- Stainless steel + silicon (let the drainer non-slip)
- Let the drainer non-slip
- Easy clean, can be rolled up

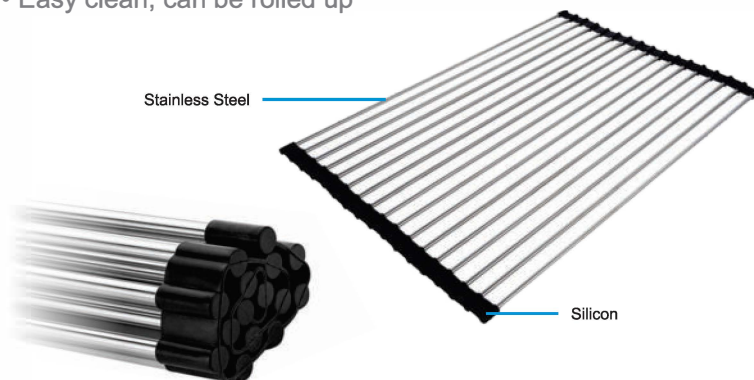

Technical Drawing:

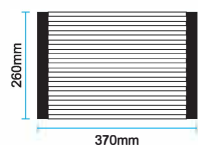

Stainless Steel Folding Roll Up Drain Shelf

Size: 370mm x 260mm (Fully Extended)

Material: Stainless Steel + Silicone Rubber

Finishing: Chromed

Packing: 1/Box , 50/Ctn

**SN-DB-3726**

